

Project name
and location

Developer's name
and address

LAYOUT CORR'D:

PLANNING MGR:

DRAWING BY:

DATE:

JOB NUMBER:

TITLE:

SHEET NUMBER:
1 OF 1

COMMENTS:
CAD ID:

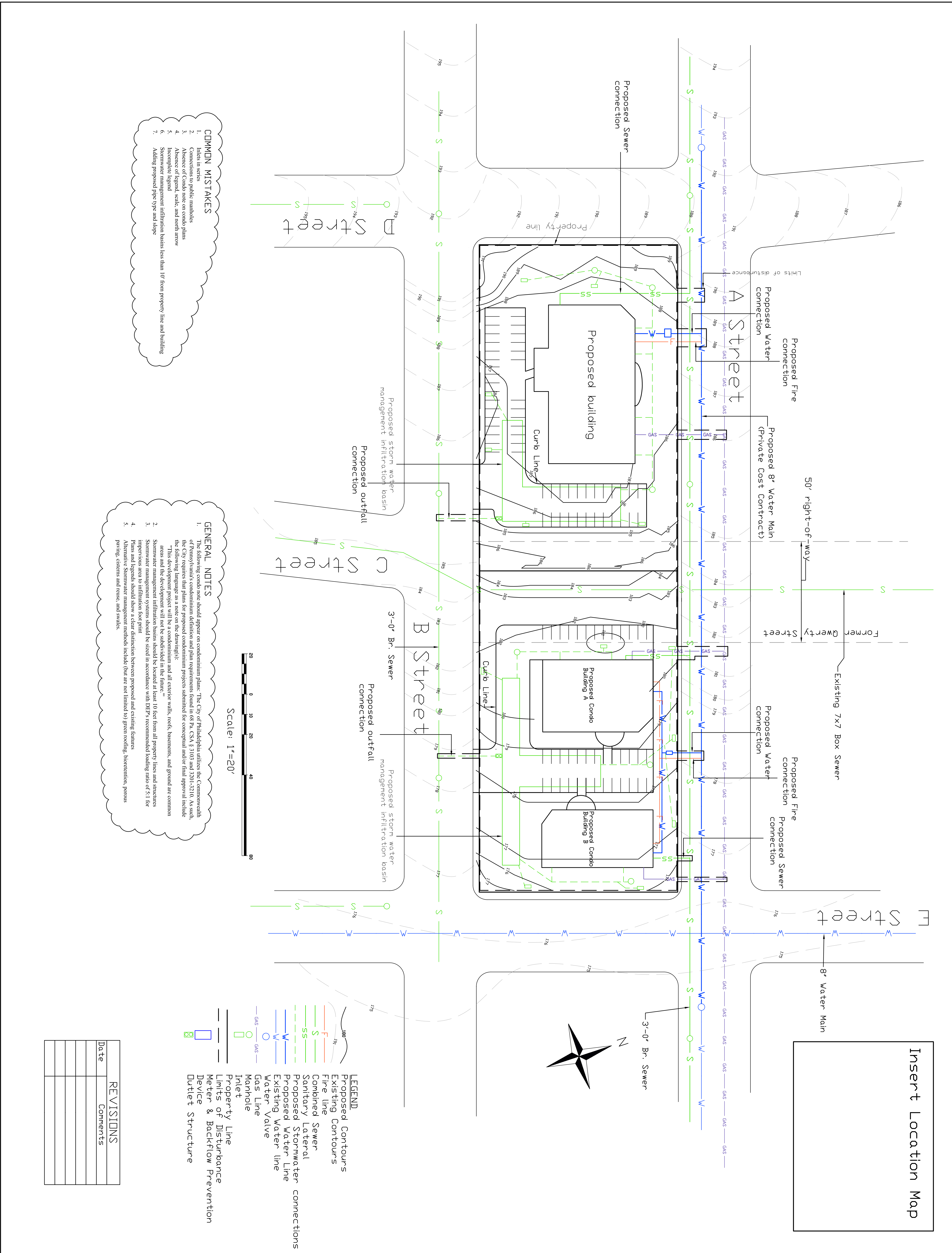

- COMMON MISTAKES**
1. Holes in series public manholes
 2. Missing manhole covers
 3. Absence of Condo note on condo plans
 4. Absence of legend, scale, and north arrow
 5. Incomplete legend
 6. Stormwater management infiltration basins less than 10' from property line and building
 7. Adding proposed pipe type and slope

- GENERAL NOTES**
1. The following condo note should appear on condominium plans: The City of Philadelphia utilizes the Commonwealth of Pennsylvania's Uniform Condominium Act (UCA) and requires that plans for proposed condominium projects submitted for conceptual and/or final approval include the following language as a note on the drawings:
"This development project will not be subdivided in the future."
2. Stormwater management infiltration basins should be located at least 10 feet from all property lines and structures. Stormwater management infiltration basins should be sized in accordance with DPW recommended loading rates of 5.1 for impervious area to infiltration flow rate.
3. Plans and legends should show a clear distinction between proposed and existing features.
4. Alternative Stormwater management methods include (but are not limited to) green roofing, bio-retention, porous paving, cisterns and fences, and swales.

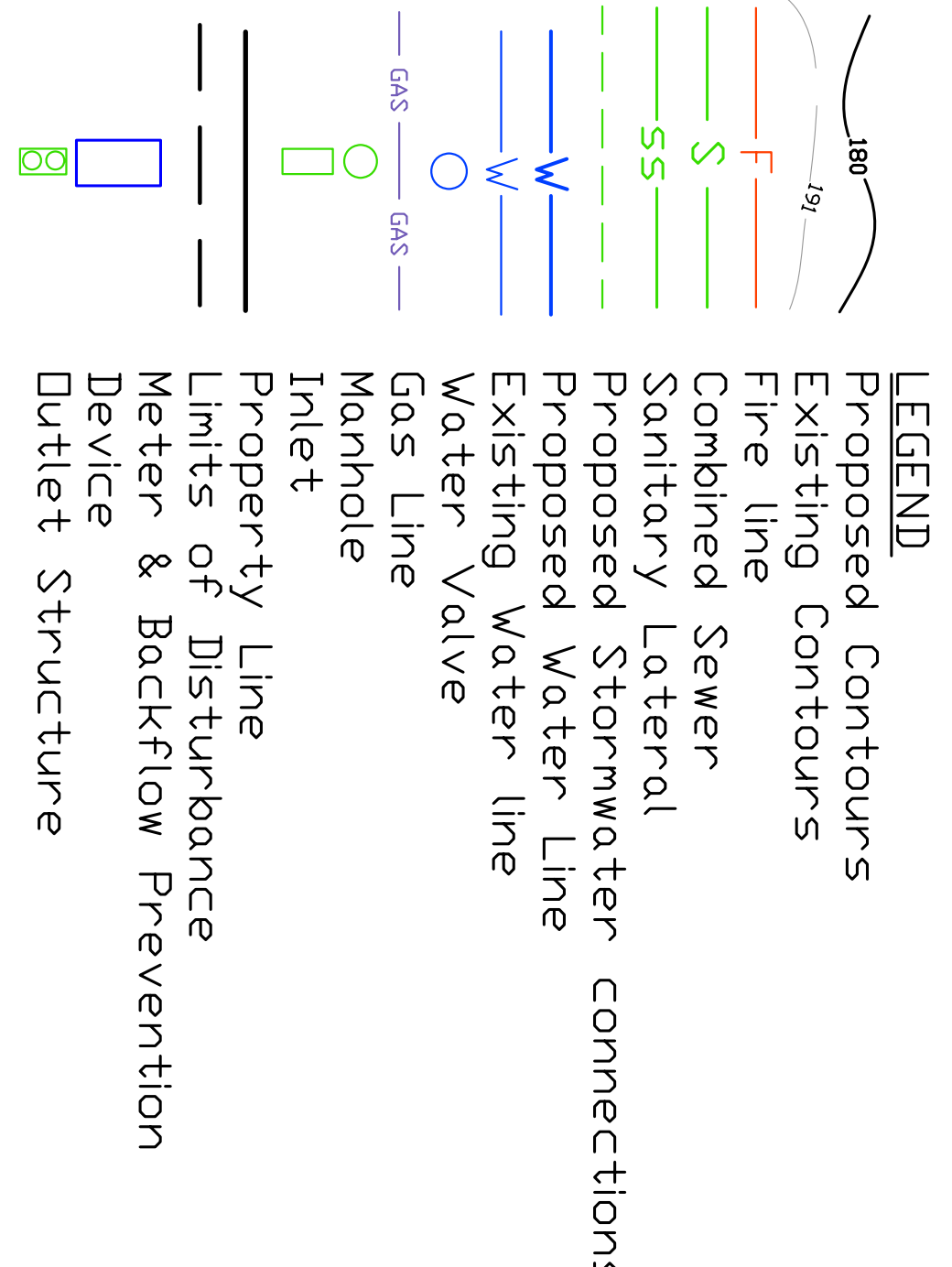

REVISIONS

Date	Comments